

CLOY MODELS 1000, 1001, 1100, 183, 186, 187 HOLMES MODELS 52, 54

REVISIONS

REV. NO.	ZONE:	DATE:	ECN NO.	APPVD:	DESCRIPTION
01	-	10/28/036	ER1022R02	SH	ADDED M/N 52, 54
02	-	12/23/03	-	RK	STRUT PATTERN WAS 'ONE EA. SECTION EXCEPT #3'

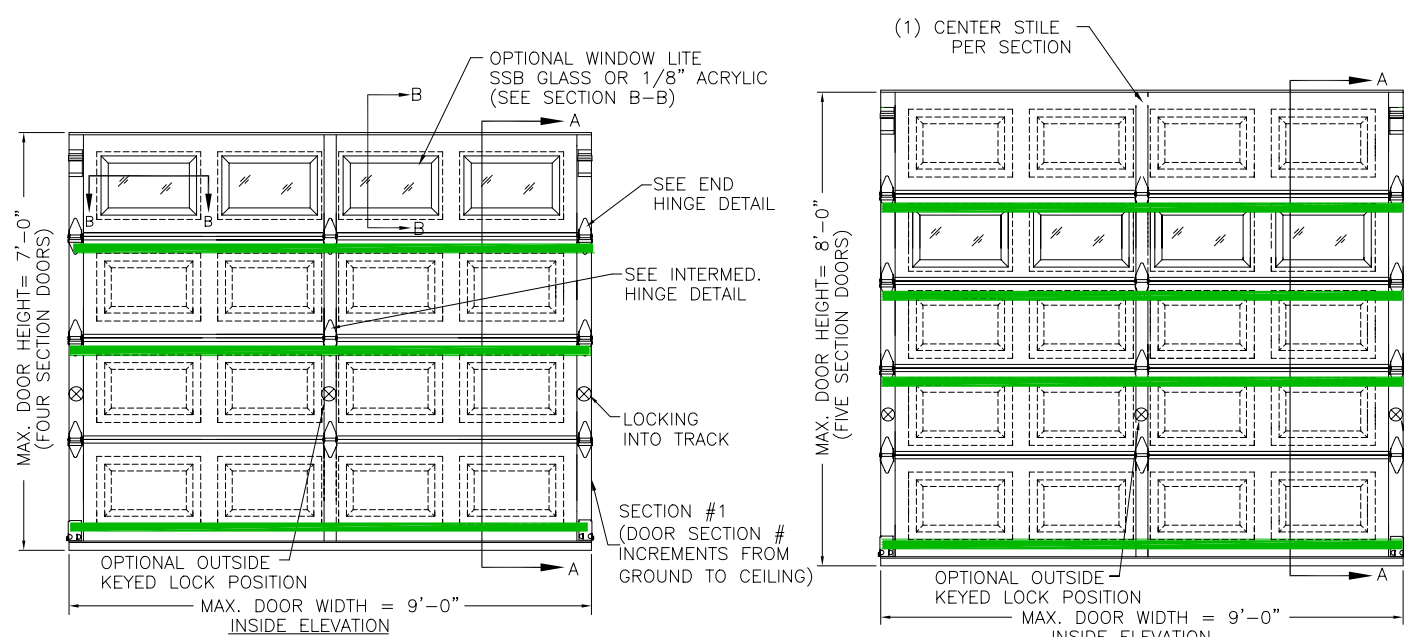

EXPANDED POLYSTYRENE FOAM INSULATION LAMINATED TO INSIDE OF EXTERIOR SKIN. 7/8" THICK.

VERTICAL JAMB ATTACHMENT (WOOD FRAME BUILDINGS):
OPTION 1: 3/8" x 3" (1-1/2" EMBED) LAG SCREWS ON 24" CENTERS. 1-1/8" O.D. MIN. WASHER REQUIRED. LAG SCREWS MAY BE COUNTERSUNK (NOT REQUIRED) TO PROVIDE FLUSH MOUNTING SURFACE.
OPTION 2: 16D x 3-1/2" (2" EMBED) COMMON WIRE NAILS ON 13" CENTERS. (HORIZONTAL JAMBS DO NOT TRANSFER LOAD.)

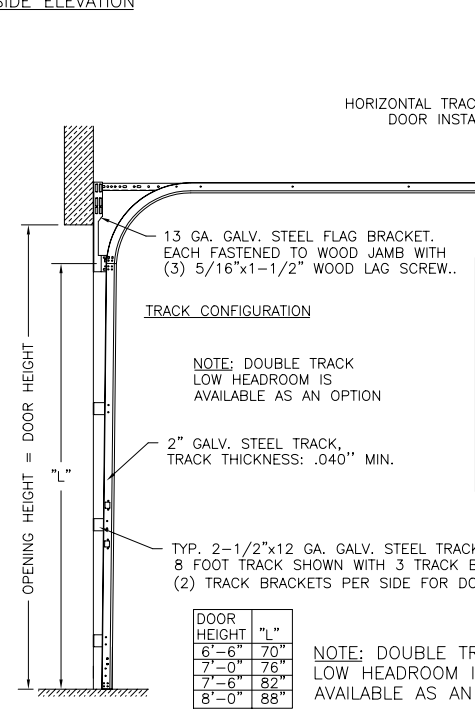
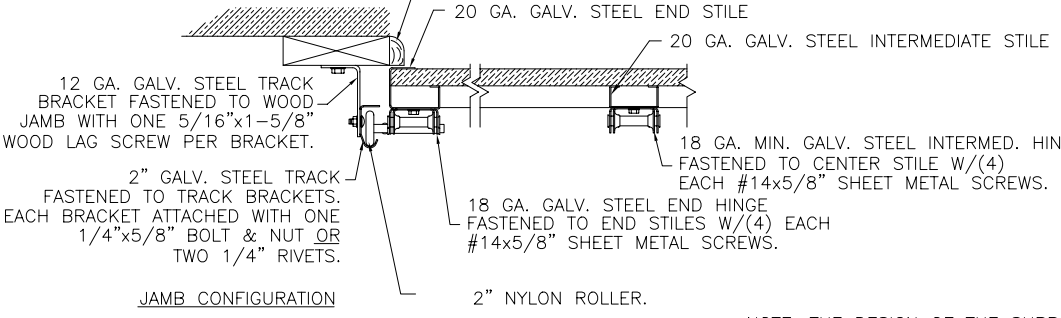
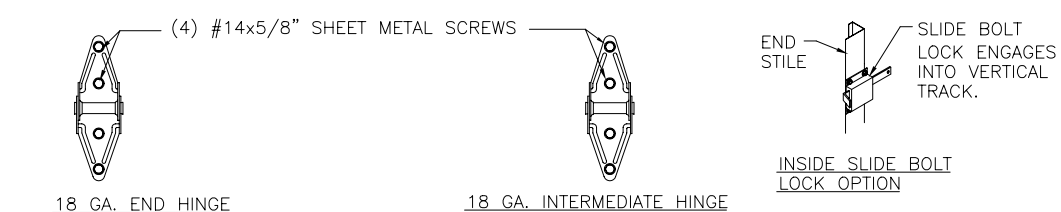
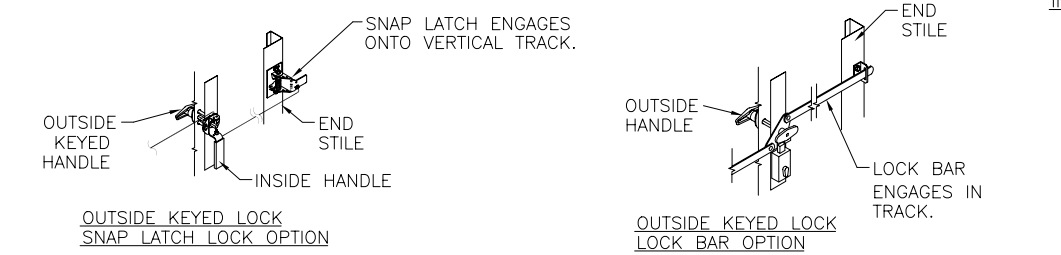
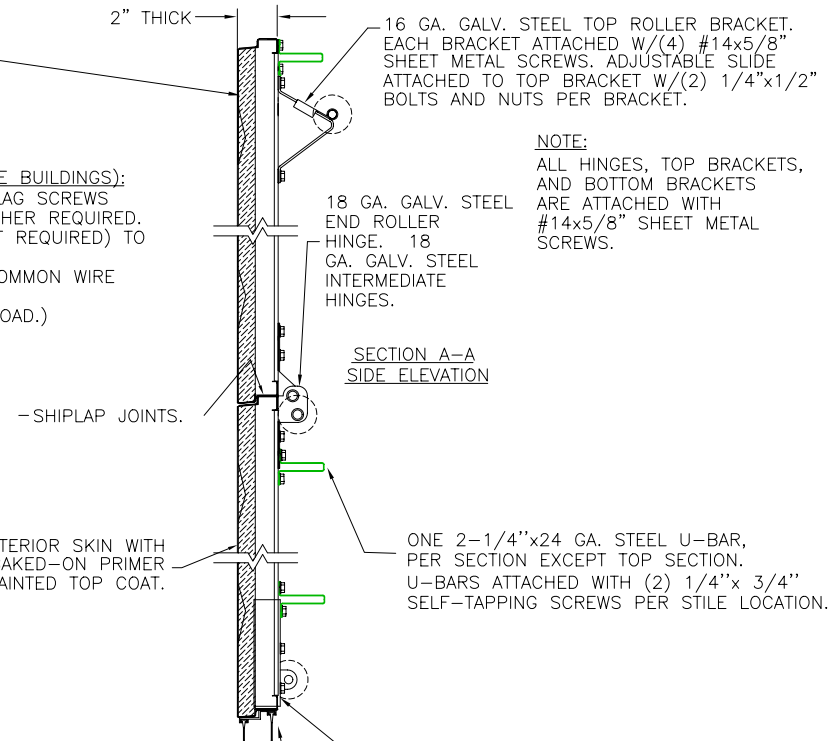

THIS DOOR MEETS OR EXCEEDS THE DESIGN LOADS FOR THE WIND SPEEDS LISTED BELOW ACCORDING TO THE 2000 INTERNATIONAL BUILDING/RESID. CODE FOR THE FOLLOWING CONDITIONS: 1) ENCLOSED BUILDING, 2) DOOR HAS 2' OF WIDTH IN BUILDING'S END ZONE, 3) IMPORTANCE FACTOR OF 1.0, 4) ANY ROOF SLOPE, AND 5) 50% SAFETY FACTOR.

WIND SPEED (MPH)	≤ 90
EXPOSURE LEVEL	B
MEAN ROOF HEIGHT	30'

NOTE: THE DESIGN OF THE SUPPORTING STRUCTURAL ELEMENTS SHALL BE THE RESPONSIBILITY OF THE PROFESSIONAL OF RECORD FOR THE BUILDING OR STRUCTURE AND IN ACCORDANCE WITH CURRENT BUILDING CODES FOR THE LOADS LISTED ON THIS DRAWING.

NOTICE:
Confidential/Proprietary information of CLOPAY BUILDING PRODUCTS CO. is contained herein and may not be disclosed, used, duplicated, made available, or distributed without its prior consent. Failure to observe this notice may result in liability for any damages and losses resulting therefrom.

Unless Stated Otherwise TOLERANCES are

.0	± .03
.00	± .015
.000	± .005
.0000	± .001
Degrees	± 1/2°

Third Angle Projection

Unless Stated Otherwise DIMENSIONS ARE IN INCHES.

Glopay Building Products Company
8585 Duke Boulevard
Mason, OH 45040
(513) 770-4800

DESCRIPTION: 1000/1001/1100/183/186/187 +13.0/-15.0 PSF DES.

DRAWN BY: DAS DATE: 11/27/02 SCALE: NTS DWG. B

CHECKED BY: DATE: SHEET 1 OF 1 SIZE B

DWG. NO.: 102708 REV. NO. 02

PART NO.:

DESIGN LOAD: +13.0 PSF, -15.0 PSF
TESTED LOAD: +19.5 PSF, -22.5 PSF