

4

3

2

1

CLOPAY MODELS: H73, H76 (25 GA. STEEL SKIN)
 CLOPAY MODEL: H94 (24 GA. STEEL SKIN)
 CLOPAY MODEL H500 (25 GA. STEEL SKIN WITH 1-5/16" THICK POLYSTYRENE FOAM INSULATION)

REVISIONS					
REV. NO.	ZONE:	DATE:	ECN NO.	APPVD:	DESCRIPTION
00	-	4/24/03	ER1022	SH	ORIGINAL ISSUE

D
C
B
A

D
C
B
A

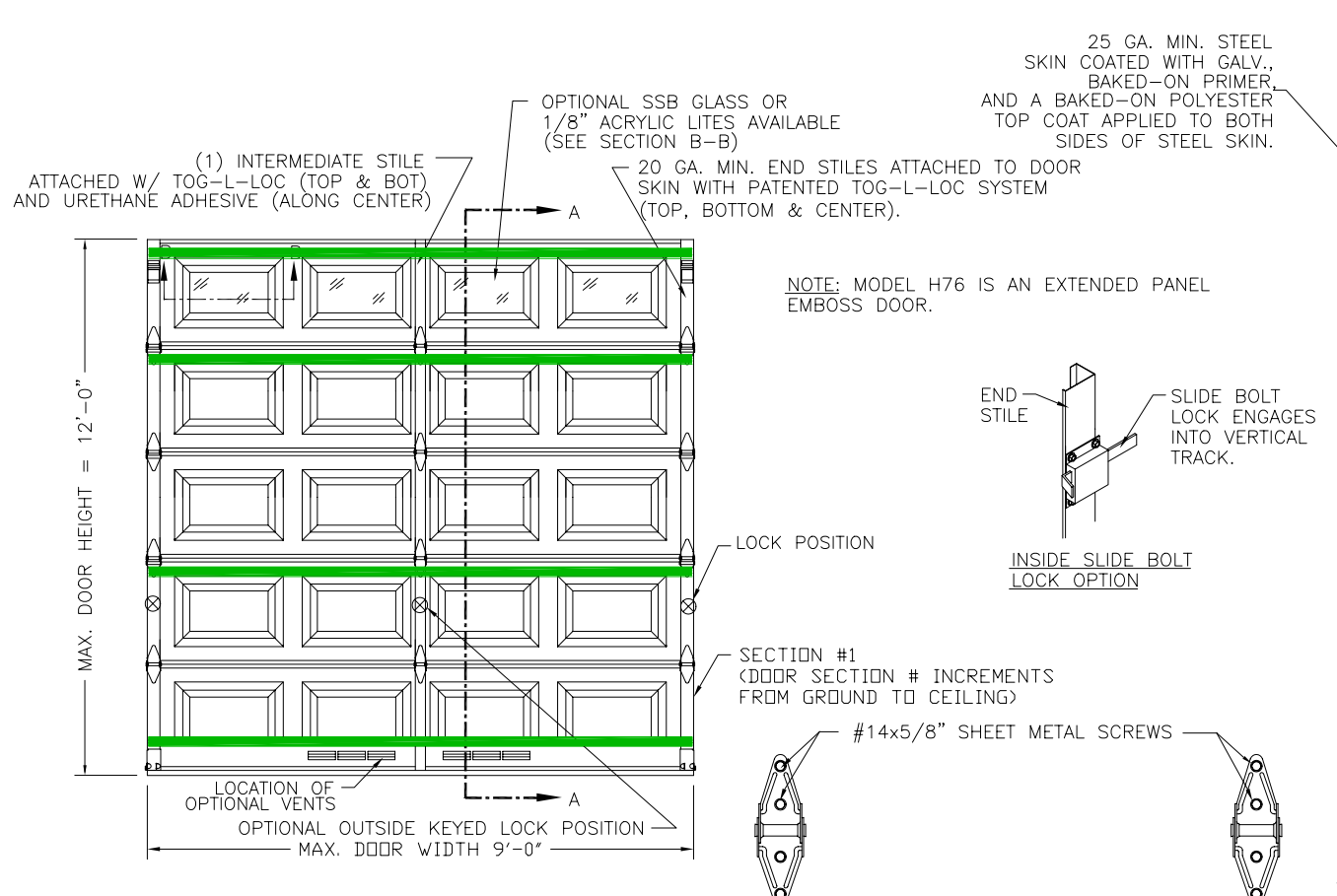

DOOR HEIGHT	# OF SECTIONS
8'-3" TO 8'-9"	5
9'-0" TO 10'-6"	6
10'-9" TO 12'-0"	7

18 GA. MIN. END HINGES VIEW "B"

18 GA. INTERMEDIATE HINGE VIEW "C"

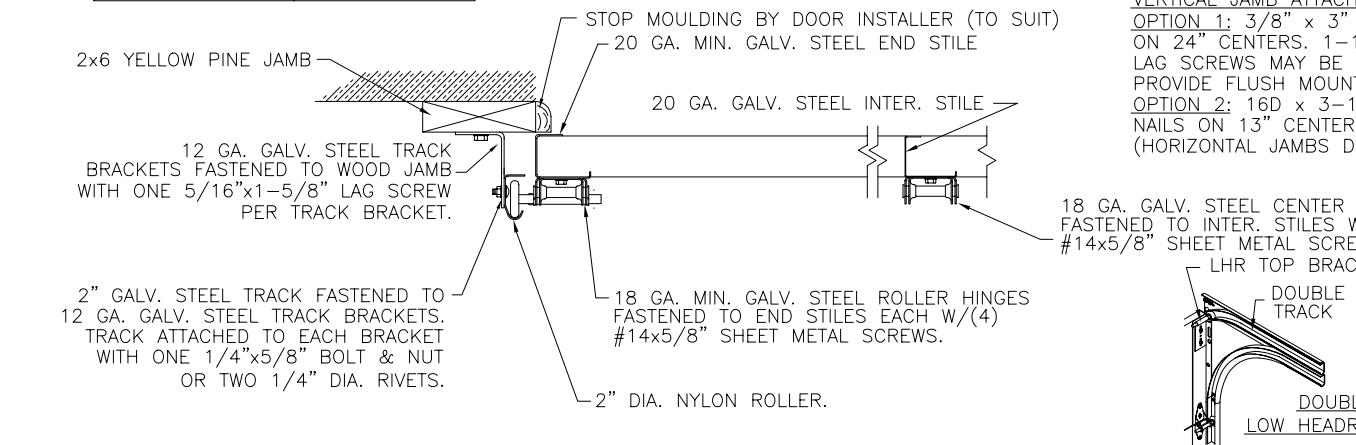

PREPARATION OF JAMBS BY OTHERS.

JAMB CONFIGURATION SECTION C-C

NOTE: THE DESIGN OF THE SUPPORTING STRUCTURAL ELEMENTS SHALL BE THE RESPONSIBILITY OF THE PROFESSIONAL OF RECORD FOR THE BUILDING OR STRUCTURE AND IN ACCORDANCE WITH CURRENT BUILDING CODES FOR THE LOADS LISTED ON THIS DRAWING.

THIS DOOR MEETS OR EXCEEDS THE DESIGN LOADS FOR THE WIND SPEEDS LISTED BELOW ACCORDING TO THE 2000 INTERNATIONAL BUILDING/RESID. CODE FOR THE FOLLOWING CONDITIONS: 1) ENCLOSED BUILDING, 2) DOOR HAS 2' OF WIDTH IN BUILDING'S END ZONE, 3) IMPORTANCE FACTOR OF 1.0, 4) ANY ROOF SLOPE, AND 5) 50% SAFETY FACTOR.

WIND SPEED (MPH)	≤ 90
EXPOSURE LEVEL	B
MEAN ROOF HEIGHT	30'

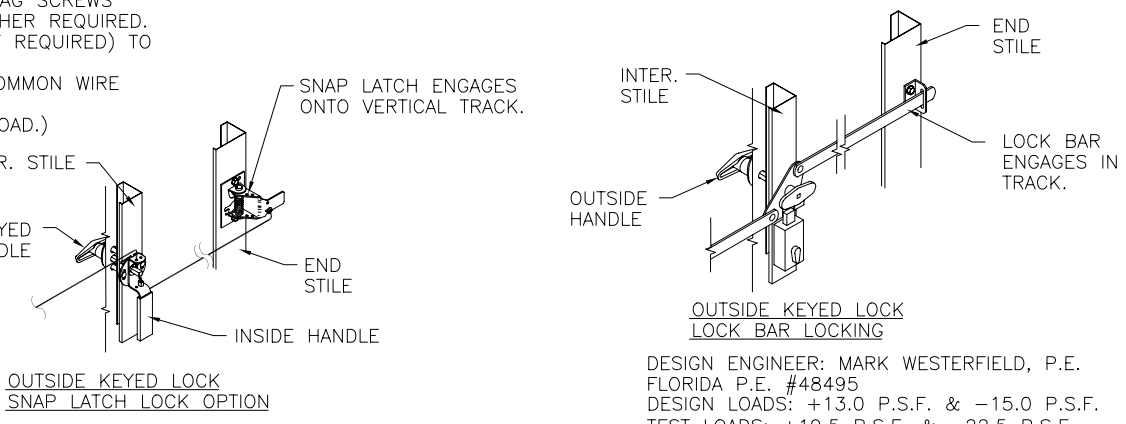
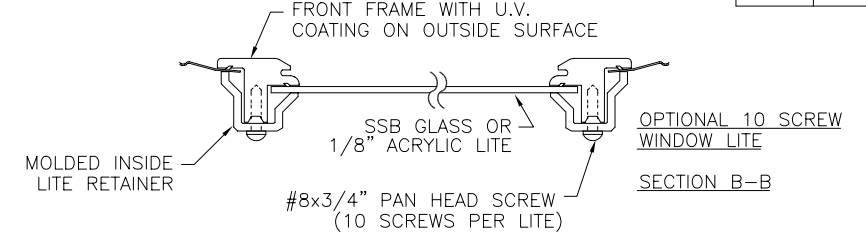
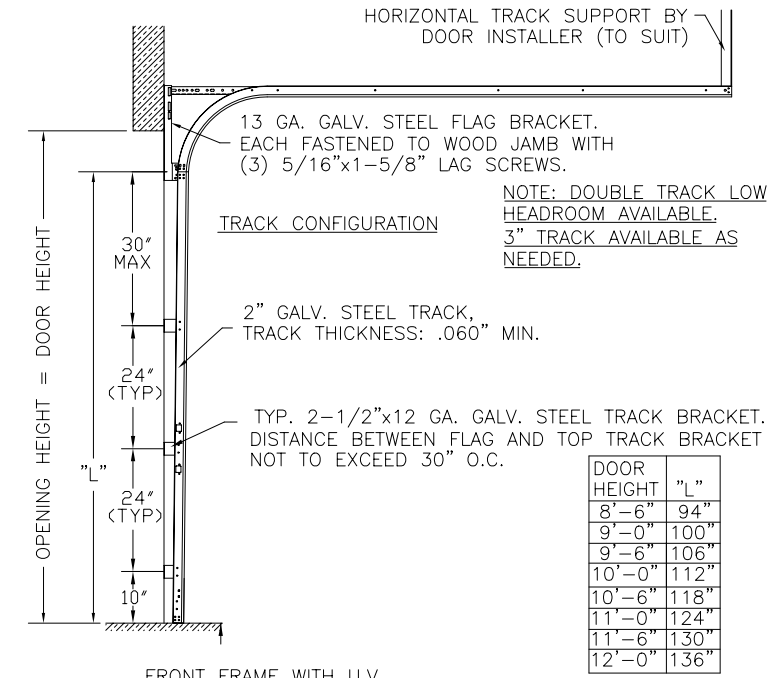
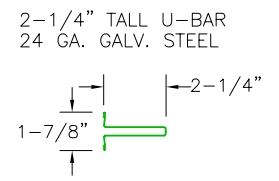

NOTICE: Confidential/Proprietary information of CLOPAY BUILDING PRODUCTS CO. is contained herein and may not be disclosed, used, duplicated, made available, or distributed, without its prior consent. Failure to observe this notice may result in liability for any damages and losses resulting therefrom.

Third Angle Projection

Unless Stated Otherwise TOLERANCES are

.0	± .03
.00	± .015
.000	± .005
.0000	± .001
Degrees	± 1/2'

Unless Stated Otherwise DIMENSIONS ARE IN INCHES.

Clipay Building Products Company

8585 Duke Boulevard
Mason, OH 45040 USA
Tel. No. 513-770-4800
Fax No. 513-770-4853

DESCRIPTION: H73 / H76 / H94 SC +13.0/-15.0 PSF

DRAWN BY: DAS	DATE: 11/27/02	SCALE: NTS	DWG. B
CHECKED BY: -	DATE: -	SHEET 1 OF 1	SIZE B

DWG. NO.: 102740

REV. NO. 00

4

3

2

1